

Razítko		Synthesia, a.s.	
<b>Protokol č. ZL2_83_2019</b>  o určení vnějších vlivů vypracovaný odbornou komisí dne 6.11.2019			
V Semtíně: 6.11.2019 Název objektu: <b>ZL2 – prostor kotelny ZL 2 - kotel K 13 (včetně pomocných provozů a vnějšího popelového hospodářství)</b>			
Členové komise:	Jméno:	Funkce:	Podpis:
Předseda: Členové:	Ing. Jiří Kočí	Vedoucí technolog TpZl	
	Jaroslav Demjančuk	Technolog kotelny	
	Stanislav Oliva	Technolog CHÚV	
	Jaroslav Písecký	Technolog odsíření a zauhlování	
	Ing. Luděk Sviták	Technolog ASŘTP	
	Ondřej Kálal	Technolog strojovny	
	František Roháč	Mechanik MaR	
	Ivo Klempíř	Mechanik ELA	
	Ing. Radim Kula	Požární preventista	
	Ing. Milena Votavova Ph.D.	Vedoucí oddělení BP	
Podklady použité pro vypracování protokolu:  ČSN 33 2000-5-51 ed. 3, ČSN EN 33 2000-1 ed. 2, ČSN EN 60079-10-1 ed. 2, ČSN EN 60079-10-2 ed. 2, ČSN 650201  Prohlídka objektu Výkresč.: 0D-29239-0050 +0m; 0D-29239-0051 +4,9m; 0D-29239-0052 +7,5m; 0D-29239-0053 +14m; 0D-29239-0054 +19,5m; 0D-29239-0055 +24,4m; 0D-29239-0056 +29,7m; 0D-29239-0057 +38m; 0D-29239-0058 +41m; 0D-29239-0059 potrubí TOT; 0D-29239-0060 doprava paliva; 0D-29239-0061 vnitřní hospodářství biomasy; 0D-29239-0062 kompresorová stanice; 0D-29239-0063 externí úletový popel.  Tabulka č. 1: Rozhodnutí Tabulka č. 2: Tabulka vlastností hořlavých látek (kapaliny, plyny, páry) Tabulka č. 3: Tabulka vlastností hořlavých látek (prachy) Tabulka č. 6: tabulka stanovení a popisů zón			
Počet stran protokolu:		21	
Protokol nahrazuje: viz druhá strana, odstavec "Tímto se ruší platnost stávajícího protokolu:".			
Kategorie objektu:		A (objekt s prostory bez nebezpečí výbuchu) B (objekt s nebezpečím výbuchu) - viz tabulka č. 6	
Popis technologického procesu a zařízení:  V prostoru je umístěn kotel K13 a jeho příslušenství, výstupní potrubí VT páry, potrubí vstříku a převáděcí potrubí páry, část zásobníků uhlí, potrubí topného oleje, kouřovody, popelové hospodářství, elektroodlučovač, kompresorová stanice. Zařízení je součástí technologického celku výroby technologické páry.			

## Z d ů v o d n ě n í

Prostory s nebezpečím výbuchu dle ČSN EN 60079-10-1 ed. 2, ČSN EN 60079-10-2 ed. 2:

Prostory s nebezpečím výbuchu - viz tabulka č. 6.

Zdůvodnění:

Jedná se o prostory v objektech s nebezpečím výbuchu - viz tabulka č. 6.

Další podmínky:

Tímto se ruší platnost stávajícího protokolu:  
Protokol č. 4R-29239-0026

V Semtíně dne:  
6.11.2019

  
podpis předsedy odborné komise

Tabulka č. 1

Rozhodnutí						
Číslo protokolu	Místnost, prostor, technologie	Teplota místnosti (°C) min - max	Lhůta prohlídek dle ČSN 332340 ed. 2 (v měsících)	Lhůta povrchového čištění elektrického zařízení (v měsících)	Vnější vlivy určené dle těchto norem: ČSN 332000-5-51 ed.3, ČSN 332000-1 ed. 2, ČSN EN 60079-10-1 ed. 2, ČSN EN 60079-10-2 ed.2, ČSN 650201	
ZL2_83_2019	B.1 Olejové hospodářství v oblasti armat. stanic v kotelně Podlaží + 7,5 m	+5 až +40 °C	netýká se	nestanovuje se	AA5, AB5, AC1, AD1, AE4, AF1, AG2, AH2, AK1, AL1, AM1, AN1, AP1, AQ1, AR1, AS1, BA1, BC4, BD1, BE2, CA1, CB1, AR1, AS1, BA1, BC4, BD1, BE2, CA1, CB1	
ZL2_83_2019	B.2 Kotelna Plošina + 0,0 m až + 29,7 m	+5 až +40 °C	netýká se	nestanovuje se	AA5, AB5, AC1, AD1, AE4, AF1, AG2, AH2, AK1, AL1, AM1, AN1, AP1, AQ1, AR1, AS1, BA1, BC4, BD1, BE2, CA1, CB1, AR1, AS1, BA1, BC4, BD1, BE2, CA1, CB1	
ZL2_83_2019	B.3 Kotelna Plošina + 29,7 m až po střeše	+5 až +60 °C	netýká se	nestanovuje se	AA6, AB5, AC1, AD1, AE4, AF1, AG2, AH2, AK1, AL1, AM1, AN1, AP1, AQ1, AR1, AS1, BA1, BC4, BD1, BE2, CA1, CB1, AR1, AS1, BA1, BC4, BD1, BE1, CA1, CB1	
ZL2_83_2019	B.4 Vnitřní prostory technologie zauhlování	+5 až +40 °C	netýká se	nestanovuje se	AA5, AB5, AC1, AD1, AE6, AF1, AG2, AH2, AK1, AL1, AM1, AN1, AP1, AQ1, AR1, AS1, BA1, BC4, BD1, BE3, CA1, CB1	
ZL2_83_2019	B.5 Místnost pro kompresorovou stanici	+5 až +40 °C	netýká se	nestanovuje se	AA5, AB5, AC1, AD1, AE1, AF1, AG2, AH2, AK1, AL1, AM1, AN1 AP1 AQ1, AR1, AS1, BA1, BC2, BD1, BE1, CA1, CB1	
ZL2_83_2019	B.6 Vnitřní prostory technologie biomasy	+5 až +40 °C	netýká se	nestanovuje se	AA5, AB7, AC1, AD1, AE4, AF1, AG2, AH2, AK1, AL1, AM1, AN1, AP1, AQ1, AR1, AS1, BA1, BC2, BD1, BE2, BE3, CA1, CB1	

ZL2_83_2019	B.7 Podružná rozvodna kotle na +7,5 m	+5 až +40 °C	netýká se	nestanovuje se	AA5, AB5, AC1, AD1, AE1, AF1, AG1, AH1, AK1, AL1, AM1, AN1, AP1, AQ1, AR1, AS1, BA4, BC2, BD1, BE1, CA1, CB1
ZL2_83_2019	B.8 Prostor vnějšího popelového hospodářství	-25 až +50 °C	netýká se	nestanovuje se	AA7, AB5, AC1, AD2, AE4, AF2, AG2, AH2, AK1, AL1, AM1, AN2, AP1, AQ2, AR2, AS2, BA1, BC3, BD1, BE1, CA1, CB1
ZL2_83_2019	B.9 Místnost pod elektrofitrem +7,5 m	+5 až +40 °C	netýká se	nestanovuje se	AA5, AB5, AC1, AD1, AE4, AF1, AG2, AH2, AK1, AL1, AM1, AN1, AP1, AQ1, AR1, AS1, BA1, BC4, BD1, BE2, CA1, CB1
ZL2_83_2019	B.10 Prostor pod elektrofitrem	+5 až +40 °C	netýká se	nestanovuje se	AA5, AB5, AC1, AD1, AE4, AF1, AG2, AH2, AK1, AL1, AM1, AN1, AP1, AQ1, AR1, AS1, BA1, BC4, BD1, BE2, CA1, CB1
ZL2_83_2019	B.11 Vnitřní prostory drtičů uhlí	+5 až +40 °C	netýká se	nestanovuje se	AA5, AB5, AC1, AD1, AE6, AF1, AG2, AH2, AK1, AL1, AM1, AN1, AP1, AQ1, AR1, AS1, BA1, BC4, BD1, BE3, CA1, CB1





Tabulka č. 3

[illegible]











1. <b>Identifikacija</b> Datum: <b>2006.04.04</b> Mesto: <b>158</b> Broj: <b>158</b>	2. <b>Opis događaja</b> Datum: <b>2006.04.04</b> Mesto: <b>158</b> Broj: <b>158</b>	3. <b>Opis događaja</b> Datum: <b>2006.04.04</b> Mesto: <b>158</b> Broj: <b>158</b>	4. <b>Opis događaja</b> Datum: <b>2006.04.04</b> Mesto: <b>158</b> Broj: <b>158</b>	5. <b>Opis događaja</b> Datum: <b>2006.04.04</b> Mesto: <b>158</b> Broj: <b>158</b>	6. <b>Opis događaja</b> Datum: <b>2006.04.04</b> Mesto: <b>158</b> Broj: <b>158</b>	7. <b>Opis događaja</b> Datum: <b>2006.04.04</b> Mesto: <b>158</b> Broj: <b>158</b>	8. <b>Opis događaja</b> Datum: <b>2006.04.04</b> Mesto: <b>158</b> Broj: <b>158</b>	9. <b>Opis događaja</b> Datum: <b>2006.04.04</b> Mesto: <b>158</b> Broj: <b>158</b>	10. <b>Opis događaja</b> Datum: <b>2006.04.04</b> Mesto: <b>158</b> Broj: <b>158</b>
---	--	--	--	--	--	--	--	--	---



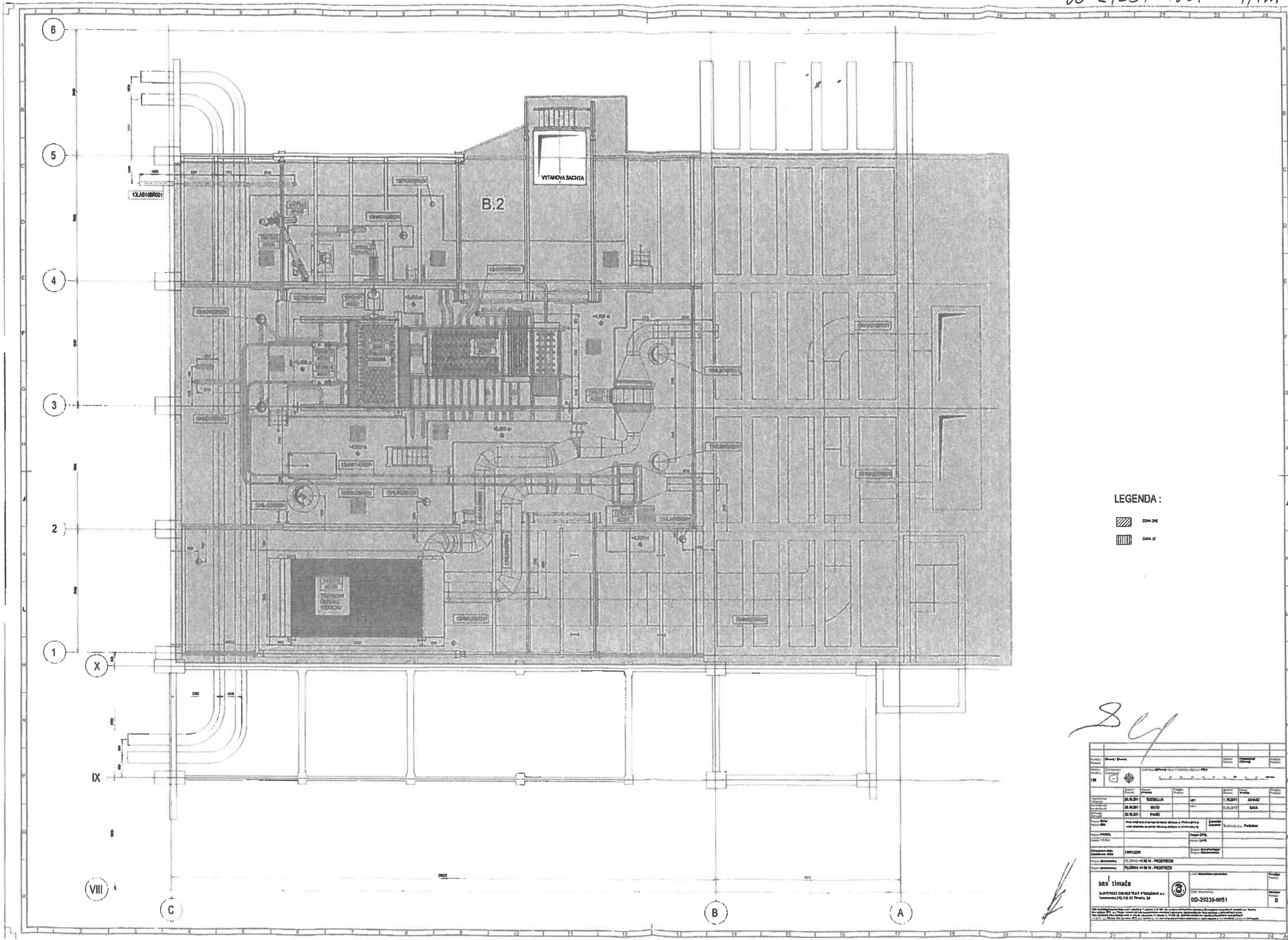





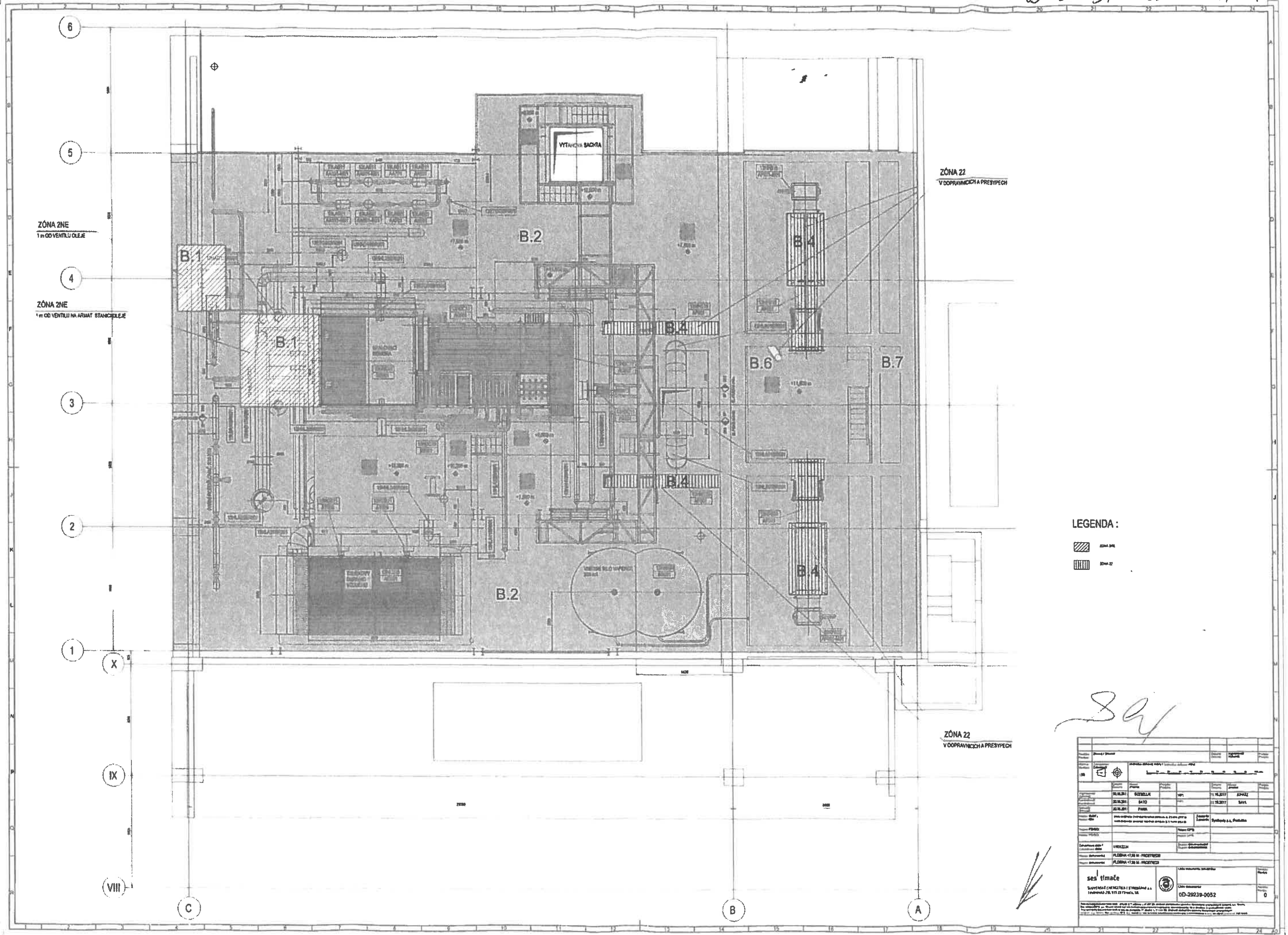





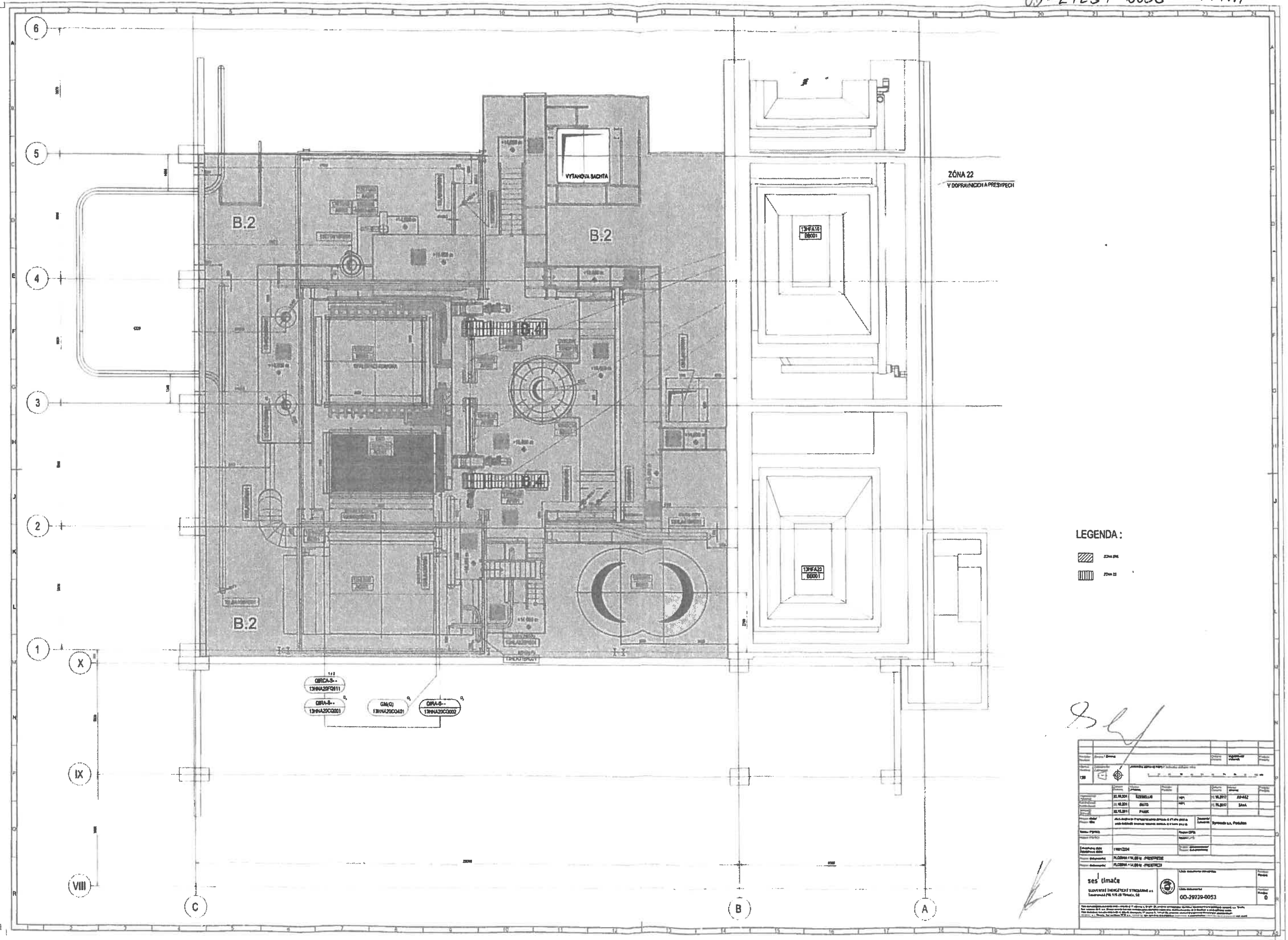



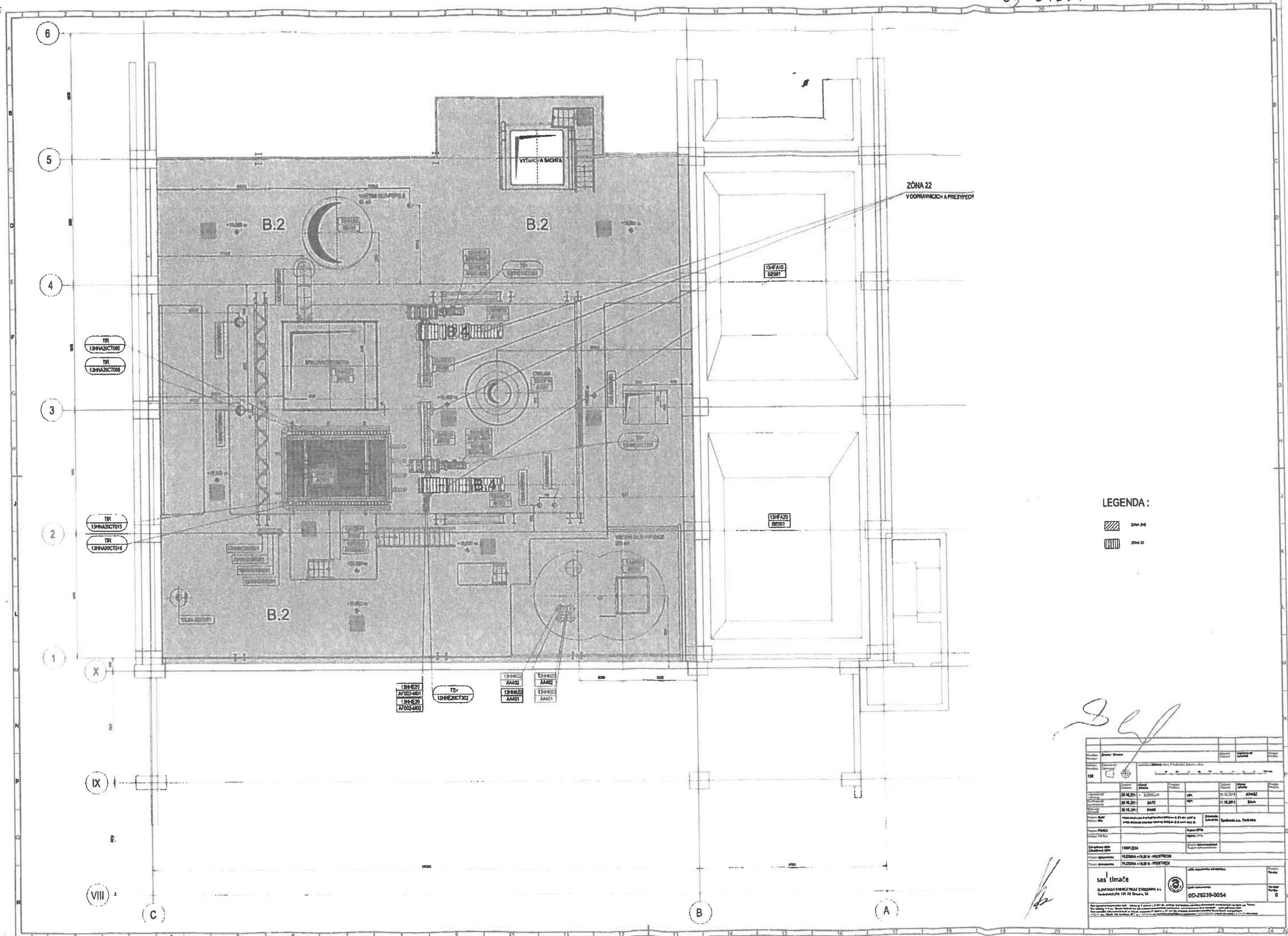



**LEGENDA:**

 220A 204

 204A 22

104-27

120 100 150 200 250 300 350 400 450 500 550 600 650 700 750 800 850 900 950 1000 1050 1100 1150 1200 1250 1300 1350 1400 1450 1500 1550 1600 1650 1700 1750 1800 1850 1900 1950 2000 2050 2100 2150 2200 2250 2300 2350 2400 2450 2500 2550 2600 2650 2700 2750 2800 2850 2900 2950 3000 3050 3100 3150 3200 3250 3300 3350 3400 3450 3500 3550 3600 3650 3700 3750 3800 3850 3900 3950 4000 4050 4100 4150 4200 4250 4300 4350 4400 4450 4500 4550 4600 4650 4700 4750 4800 4850 4900 4950 5000 5050 5100 5150 5200 5250 5300 5350 5400 5450 5500 5550 5600 5650 5700 5750 5800 5850 5900 5950 6000 6050 6100 6150 6200 6250 6300 6350 6400 6450 6500 6550 6600 6650 6700 6750 6800 6850 6900 6950 7000 7050 7100 7150 7200 7250 7300 7350 7400 7450 7500 7550 7600 7650 7700 7750 7800 7850 7900 7950 8000 8050 8100 8150 8200 8250 8300 8350 8400 8450 8500 8550 8600 8650 8700 8750 8800 8850 8900 8950 9000 9050 9100 9150 9200 9250 9300 9350 9400 9450 9500 9550 9600 9650 9700 9750 9800 9850 9900 9950 10000 10050 10100 10150 10200 10250 10300 10350 10400 10450 10500 10550 10600 10650 10700 10750 10800 10850 10900 10950 11000 11050 11100 11150 11200 11250 11300 11350 11400 11450 11500 11550 11600 11650 11700 11750 11800 11850 11900 11950 12000 12050 12100 12150 12200 12250 12300 12350 12400 12450 12500 12550 12600 12650 12700 12750 12800 12850 12900 12950 13000 13050 13100 13150 13200 13250 13300 13350 13400 13450 13500 13550 13600 13650 13700 13750 13800 13850 13900 13950 14000 14050 14100 14150 14200 14250 14300 14350 14400 14450 14500 14550 14600 14650 14700 14750 14800 14850 14900 14950 15000 15050 15100 15150 15200 15250 15300 15350 15400 15450 15500 15550 15600 15650 15700 15750 15800 15850 15900 15950 16000 16050 16100 16150 16200 16250 16300 16350 16400 16450 16500 16550 16600 16650 16700 16750 16800 16850 16900 16950 17000 17050 17100 17150 17200 17250 17300 17350 17400 17450 17500 17550 17600 17650 17700 17750 17800 17850 17900 17950 18000 18050 18100 18150 18200 18250 18300 18350 18400 18450 18500 18550 18600 18650 18700 18750 18800 18850 18900 18950 19000 19050 19100 19150 19200 19250 19300 19350 19400 19450 19500 19550 19600 19650 19700 19750 19800 19850 19900 19950 20000 20050 20100 20150 20200 20250 20300 20350 20400 20450 20500 20550 20600 20650 20700 20750 20800 20850 20900 20950 21000 21050 21100 21150 21200 21250 21300 21350 21400 21450 21500 	
--	--



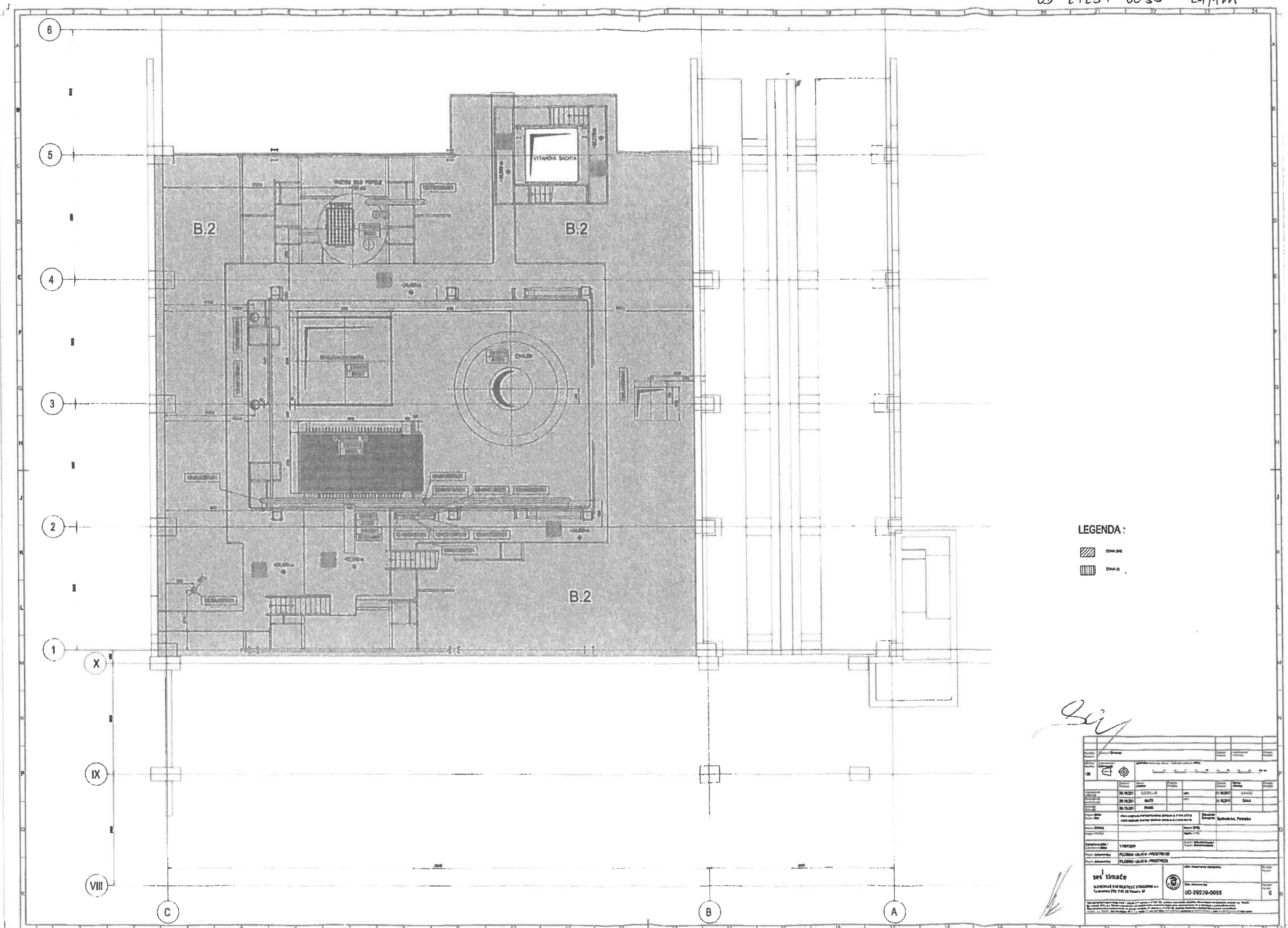





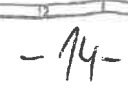

 ZONE 20

 ZONE 22

[illegible]







- 15 -



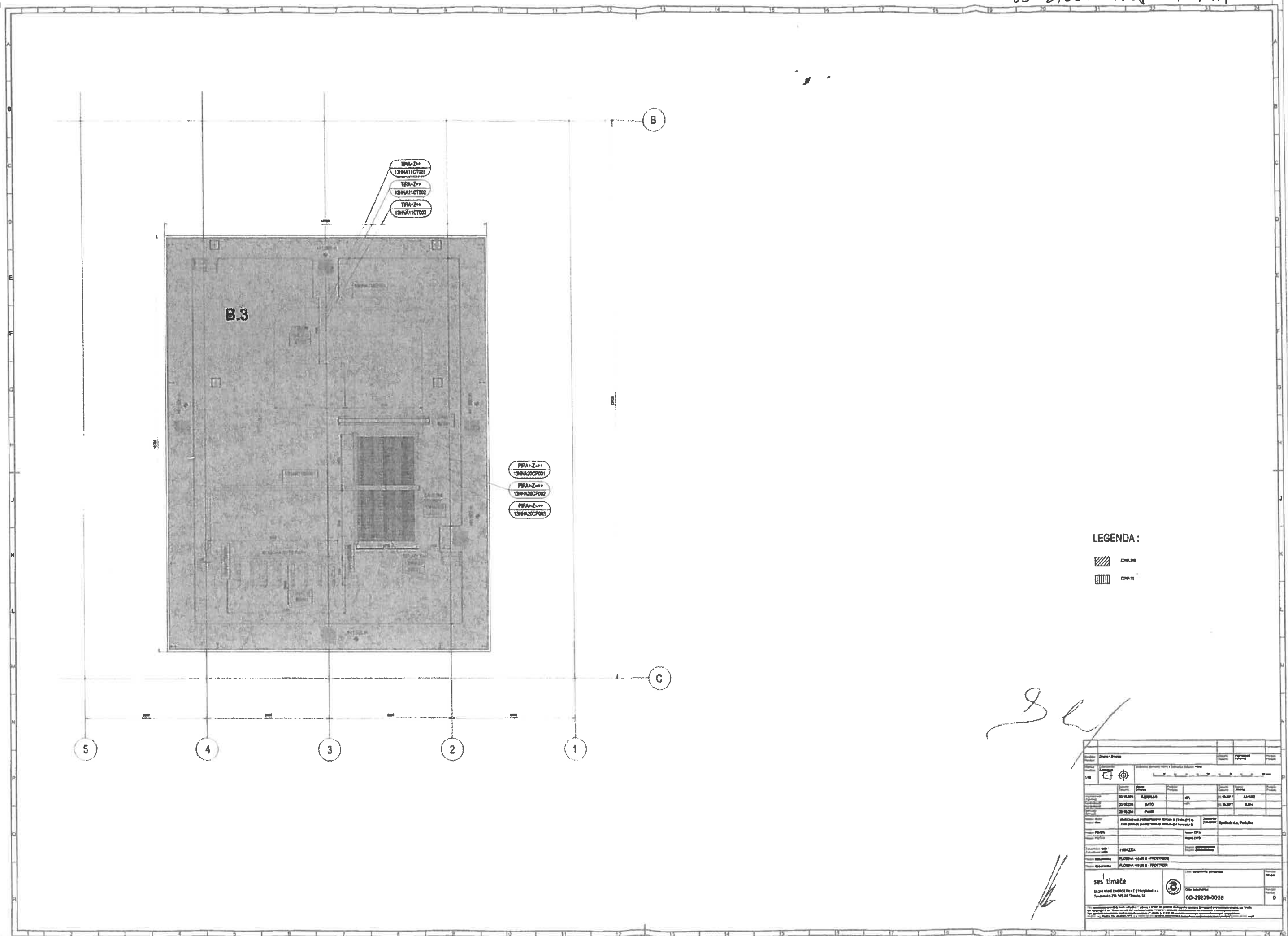



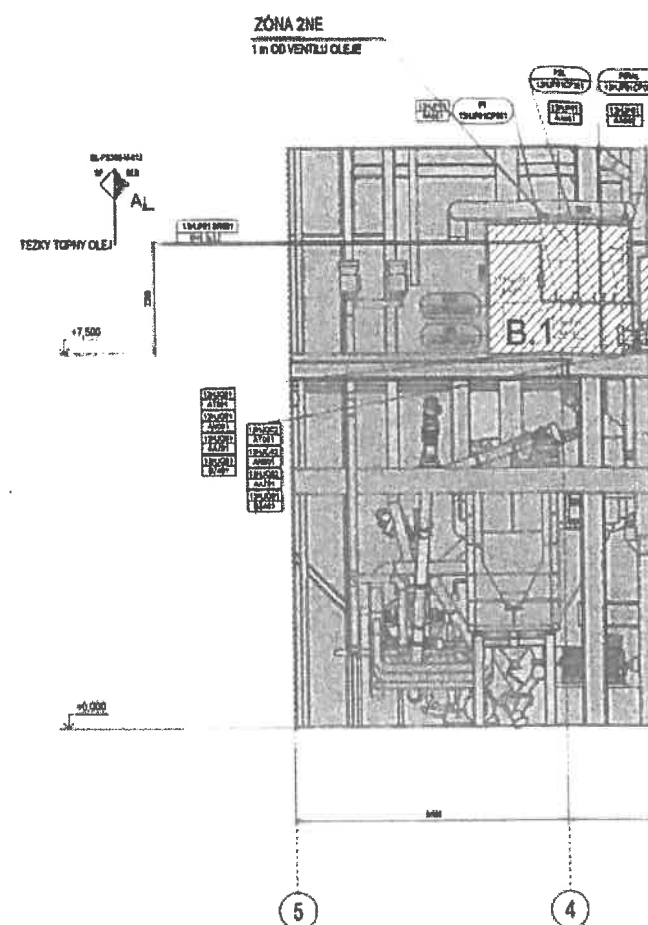

Rez A-A

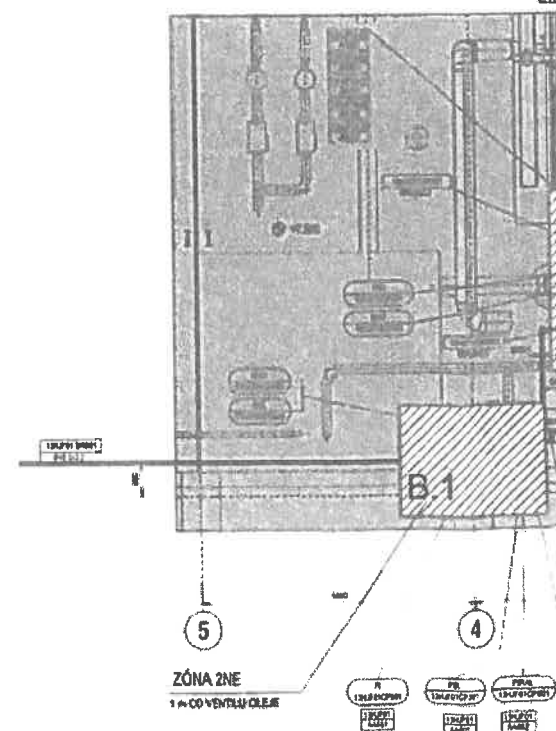





**LEGENDA :**

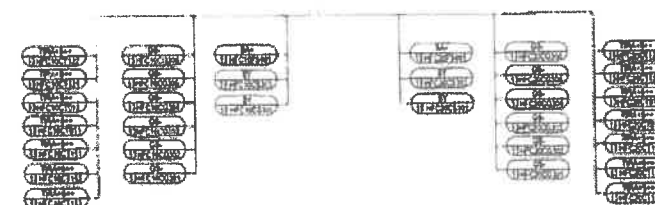
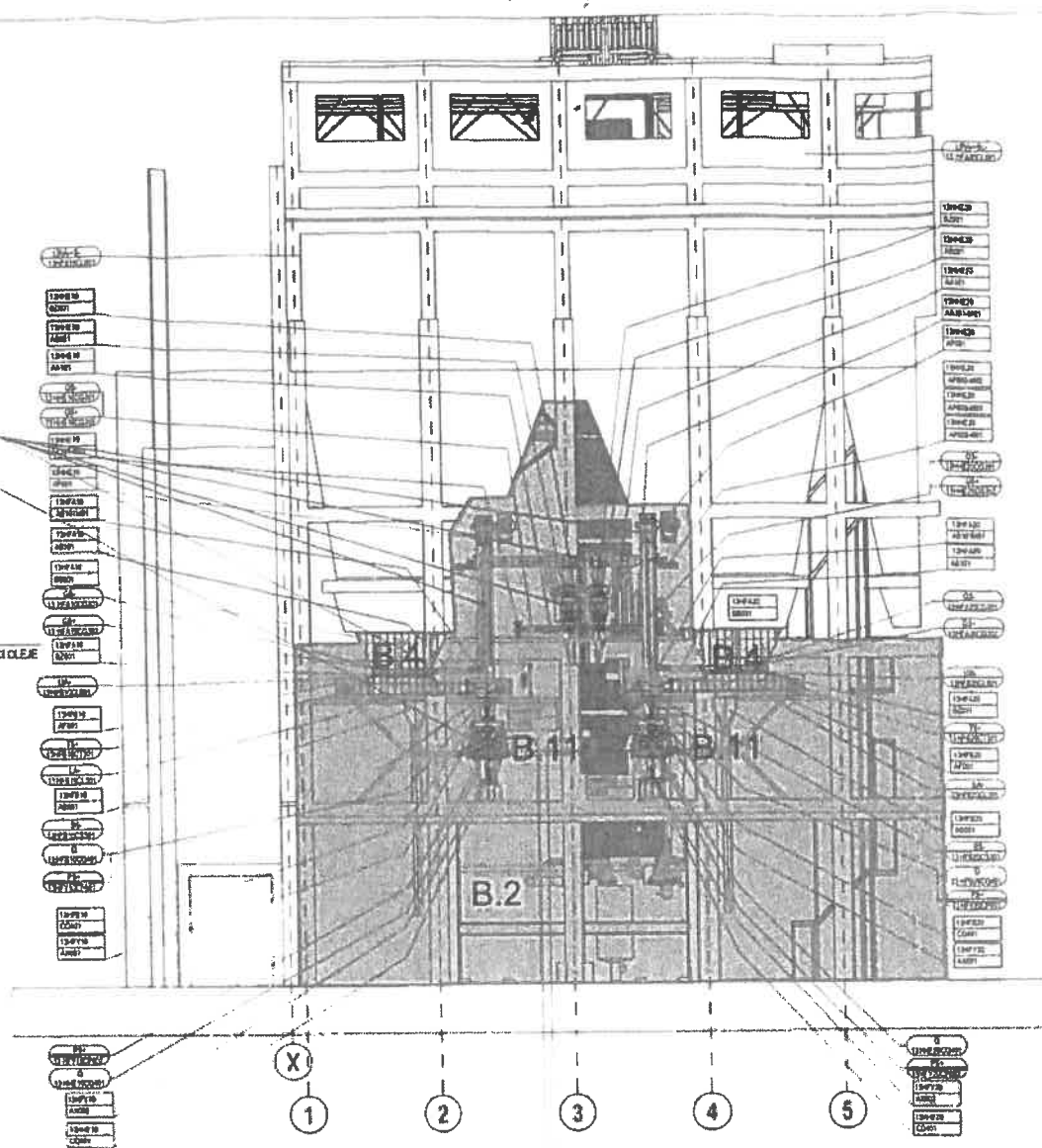
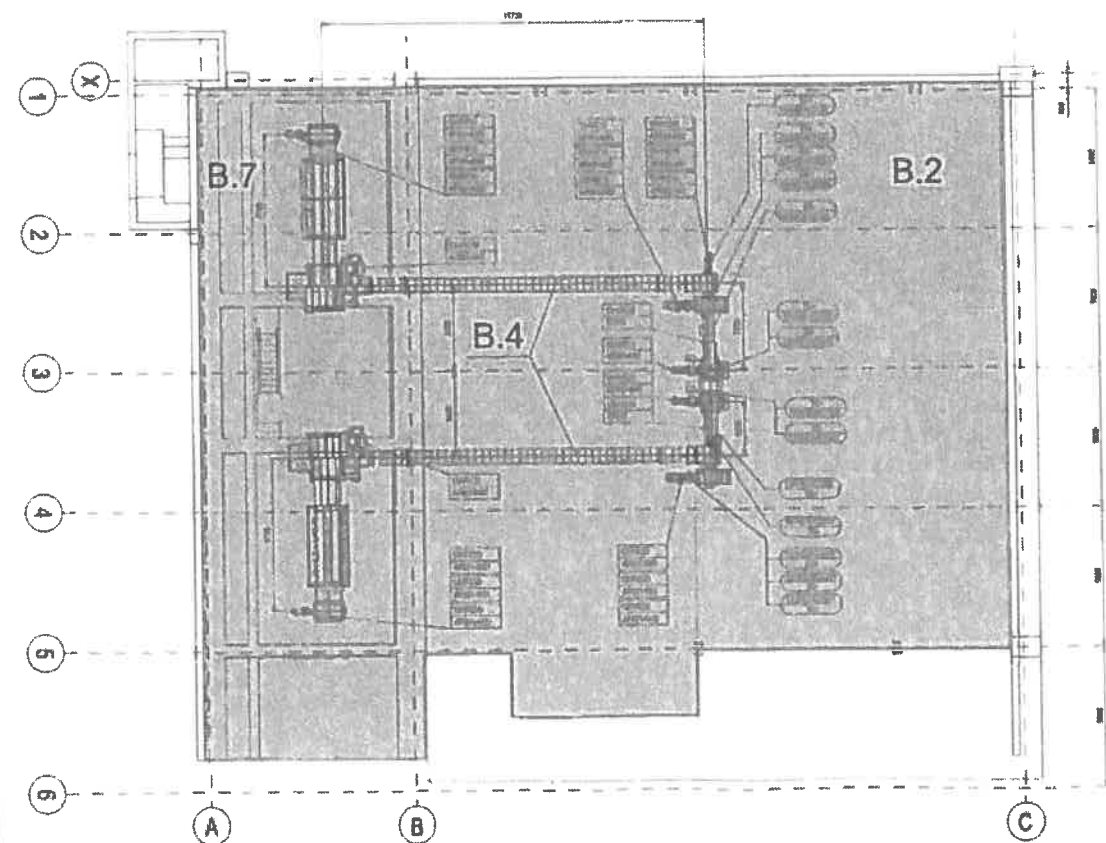

1 - 2 member 3 - 4 member 5 - 6 member 7 - 8 member 9 - 10 member 11 - 12 member 13 - 14 member 15 - 16 member 17 - 18 member 19 - 20 member 21 - 22 member 23 - 24 member 25 - 26 member 27 - 28 member 29 - 30 member 31 - 32 member 33 - 34 member 35 - 36 member 37 - 38 member 39 - 40 member 41 - 42 member 43 - 44 member 45 - 46 member 47 - 48 member 49 - 50 member 51 - 52 member 53 - 54 member 55 - 56 member 57 - 58 member 59 - 60 member 61 - 62 member 63 - 64 member 65 - 66 member 67 - 68 member 69 - 70 member 71 - 72 member 73 - 74 member 75 - 76 member 77 - 78 member 79 - 80 member 81 - 82 member 83 - 84 member 85 - 86 member 87 - 88 member 89 - 90 member 91 - 92 member 93 - 94 member 95 - 96 member 97 - 98 member 99 - 100 member 101 - 102 member 103 - 104 member 105 - 106 member 107 - 108 member 109 - 110 member 111 - 112 member 113 - 114 member 115 - 116 member 117 - 118 member 119 - 120 member 121 - 122 member 123 - 124 member 125 - 126 member 127 - 128 member 129 - 130 member 131 - 132 member 133 - 134 member 135 - 136 member 137 - 138 member 139 - 140 member 141 - 142 member 143 - 144 member 145 - 146 member 147 - 148 member 149 - 150 member 151 - 152 member 153 - 154 member 155 - 156 member 157 - 158 member 159 - 160 member 161 - 162 member 163 - 164 member 165 - 166 member 167 - 168 member 169 - 170 member 171 - 172 member 173 - 174 member 175 - 176 member 177 - 178 member 179 - 180 member 181 - 182 member 183 - 184 member 185 - 186 member 187 - 188 member 189 - 190 member 191 - 192 member 193 - 194 member 195 - 196 member 197 - 198 member 199 - 200 member 201 - 202 member 203 - 204 member 205 - 206 member 207 - 208 member 209 - 210 member 211 - 212 member 213 - 214 member 215 - 216 member 217 - 218 member 219 - 220 member 221 - 222 member 223 - 224 member 225 - 226 member 227 - 228 member 229 - 230 member 231 - 232 member 233 - 234 member 235 - 236 member 237 - 238 member 239 - 240 member 241 - 242 member 243 - 244 member 245 - 246 member 247 - 248 member 249 - 250 member 251 - 252 member 253 - 254 member 255 - 256 member 257 - 258 member 259 - 260 member 261 - 262 member 263 - 264 member 265 - 266 member 267 - 268 member 269 - 270 member 271 - 272 member 273 - 274 member 275 - 276 member 277 - 278 member 279 - 280 member 281 - 282 member 283 - 284 member 285 - 286 member 287 - 288 member 289 - 290 member 291 - 292 member 293 - 294 member 295 - 296 member 297 - 298 member 299 - 300 member 301 - 302 member 303 - 304 member 305 - 306 member 307 - 308 member 309 - 310 member 311 - 312 member 313 - 314 member 315 - 316 member 317 - 318 member 319 - 320 member 321 - 322 member 323 - 324 member 325 - 326 member 327 - 328 member 329 - 330 member 331 - 332 member 333 - 334 member 335 - 336 member 337 - 338 member 339 - 340 member 341 - 342 member 343 - 344 member 345 - 346 member 347 - 348 member 349 - 350 member 351 - 352 member 353 - 354 member 355 - 356 member 357 - 358 member 359 - 360 member 361 - 362 member 363 - 364 member 365 - 366 member 367 - 368 member 369 - 370 member 371 - 372 member 373 - 374 member 375 - 376 member 377 - 378 member 379 - 380 member 381 - 382 member 383 - 384 member 385 - 386 member 387 - 388 member 389 - 390 member 391 - 392 member 393 - 394 member 395 - 396 member 397 - 398 member 399 - 400 member 401 - 402 member 403 - 404 member 405 - 406 member 407 - 408 member 409 - 410 member 411 - 412 member 413 - 414 member 415 - 416 member 417 - 418 member 419 - 420 member 421 - 422 member 423 - 424 member 425 - 426 member 427 - 428 member 429 - 430 member 431 - 432 member 433 - 434 member 435 - 436 member 437 - 438 member 439 - 440 member 441 - 442 member 443 - 444 member 445 - 446 member 447 - 448 member 449 - 450 member 451 - 452 member 453 - 454 member 455 - 456 member 457 - 458 member 459 - 460 member 461 - 462 member 463 - 464 member 465 - 466 member 467 - 468 member 469 - 470 member 471 - 472 member 473 - 474 member 475 - 476 member 477 - 478 member 479 - 480 member 481 - 482 member 483 - 484 member 485 - 486 member 487 - 488 member 489 - 490 member 491 - 492 member 493 - 494 member 495 - 496 member 497 - 498 member 499 - 500 member 501 - 502 member 503 - 504 member 505 - 506 member 507 - 508 member 509 - 510 member 511 - 512 member 513 - 514 member 515 - 516 member 517 - 518 member 519 - 520 member 521 - 522 member 523 - 524 member 525 - 526 member 527 - 528 member 529 - 530 member 531 - 532 member 533 - 534 member 535 - 536 member 537 - 538 member 539 - 540 member 541 - 542 member 543 - 544 member 545 - 546 member 547 - 548 member 549 - 550 member 551 - 552 member 553 - 554 member 555 - 556 member 557 - 558 member 559 - 560 member 561 - 562 member 563 - 564 member 565 - 566 member 567 - 568 member 569 - 570 member 571 - 572 member 573 - 574 member 575 - 576 member 577 - 578 member 579 - 580 member 581 - 582 member 583 - 584 member 585 - 586 member 587 - 588 member 589 - 590 member 591 - 592 member 593 - 594 member 59	
--	--





	27000 20
	27000 30
	27000 40

[illegible]





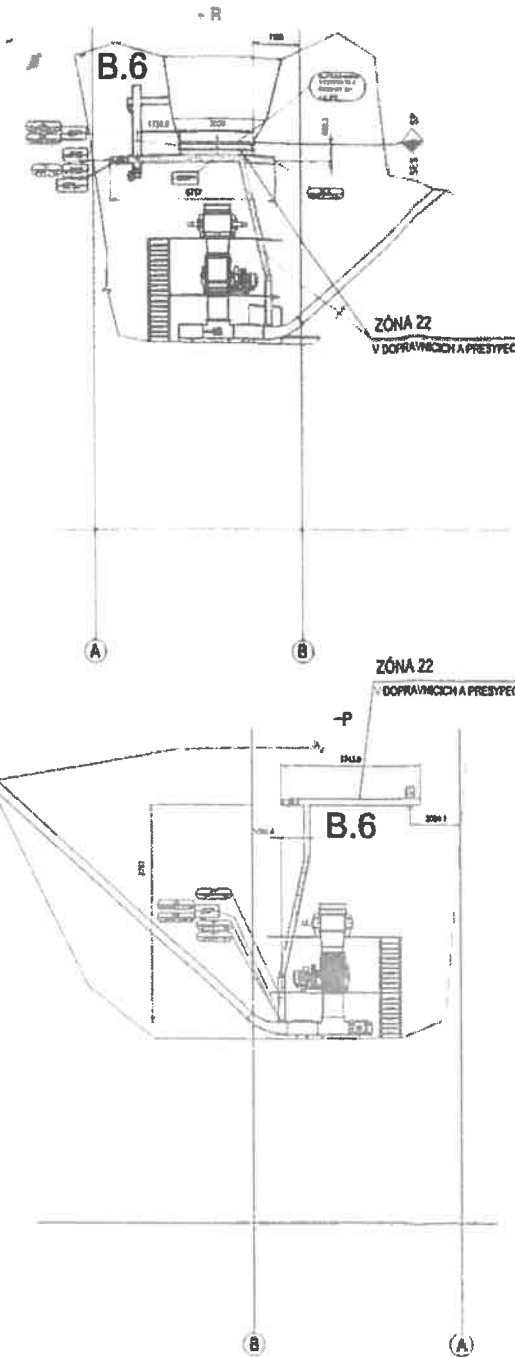
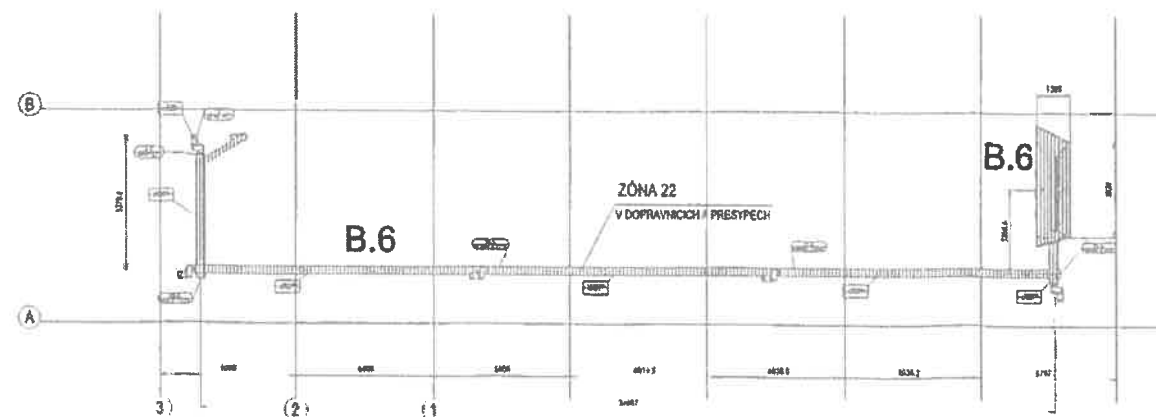
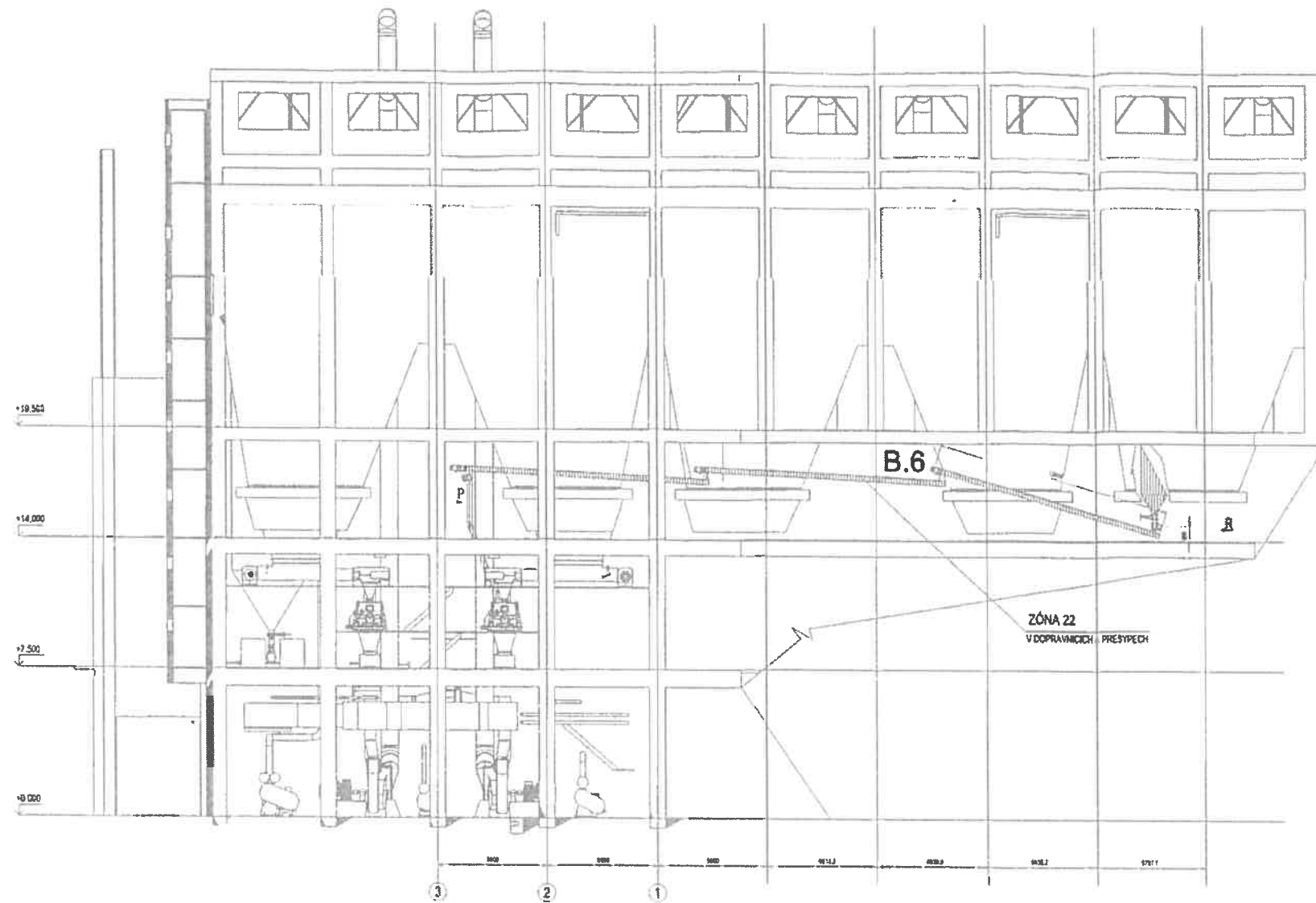

LEGENDA:



Název stavby / Objekt		Město / Okres		Stavba / Objekt	
00-29239-0061		Praha / Praha		Vnitřní hospodářství ZIOMASY	
Zpracoval / Vypracoval		Kontrola / Schválil		Datum / Město	
J. Hlaváček		J. Hlaváček		1. 12. 2011 / Praha	
Název stavby / Objekt		Město / Okres		Stavba / Objekt	
00-29239-0061		Praha / Praha		Vnitřní hospodářství ZIOMASY	
Zpracoval / Vypracoval		Kontrola / Schválil		Datum / Město	
J. Hlaváček		J. Hlaváček		1. 12. 2011 / Praha	
Název stavby / Objekt		Město / Okres		Stavba / Objekt	
00-29239-0061		Praha / Praha		Vnitřní hospodářství ZIOMASY	
Zpracoval / Vypracoval		Kontrola / Schválil		Datum / Město	
J. Hlaváček		J. Hlaváček		1. 12. 2011 / Praha	



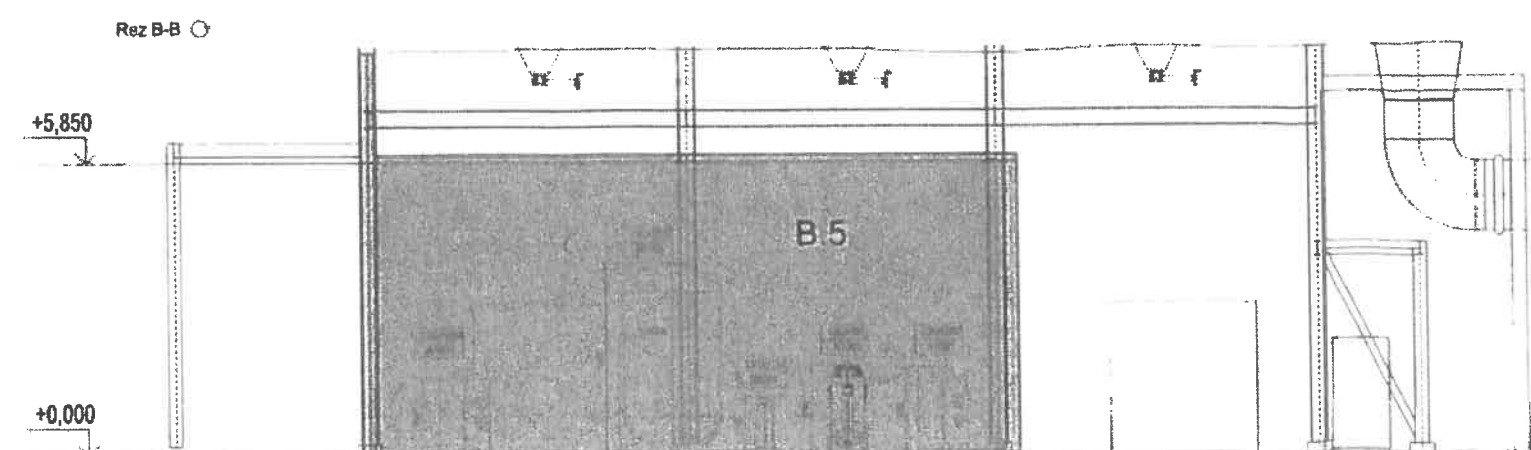
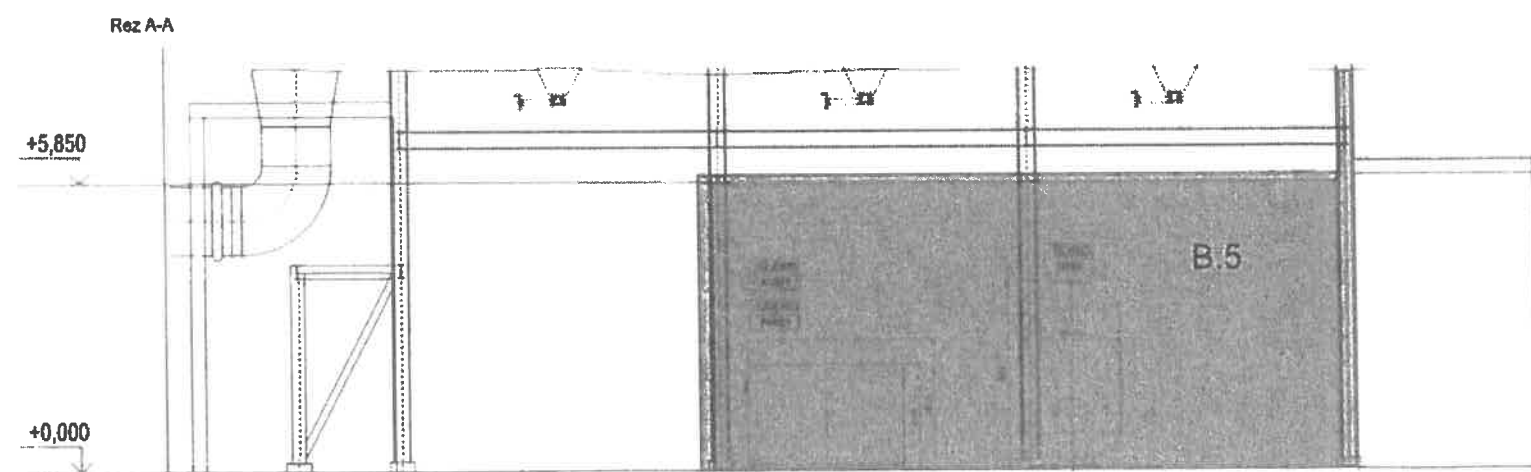
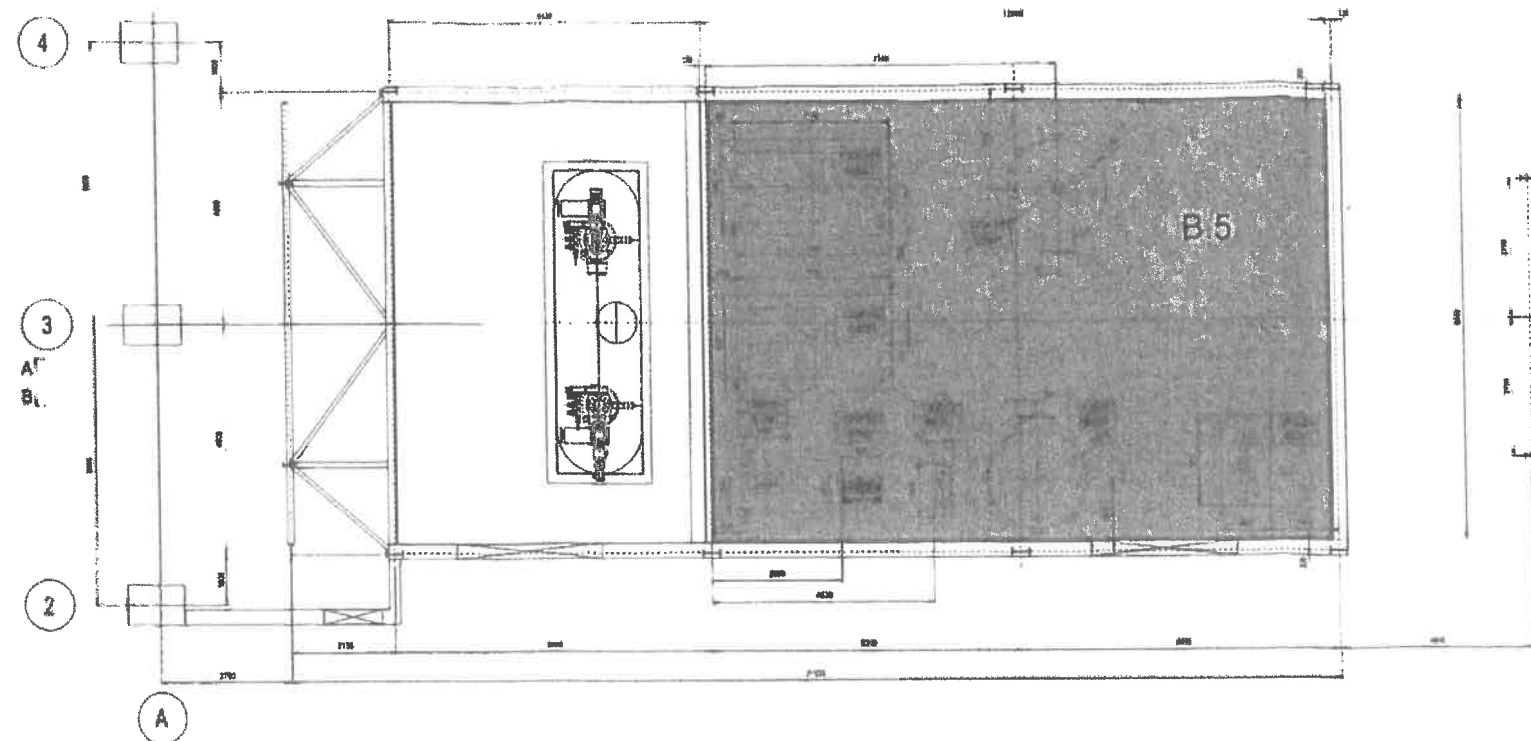

LEGENDA :

- Zóna B5
- Zóna B

36

Dátum : 2008		Miesto : Bratislava	
Stav : 1	Stav : 2	Stav : 3	Stav : 4
Stav : 5	Stav : 6	Stav : 7	Stav : 8
Stav : 9	Stav : 10	Stav : 11	Stav : 12
Stav : 13	Stav : 14	Stav : 15	Stav : 16
Stav : 17	Stav : 18	Stav : 19	Stav : 20
Stav : 21	Stav : 22	Stav : 23	Stav : 24
Stav : 25	Stav : 26	Stav : 27	Stav : 28
Stav : 29	Stav : 30	Stav : 31	Stav : 32
Stav : 33	Stav : 34	Stav : 35	Stav : 36
Stav : 37	Stav : 38	Stav : 39	Stav : 40
Stav : 41	Stav : 42	Stav : 43	Stav : 44
Stav : 45	Stav : 46	Stav : 47	Stav : 48
Stav : 49	Stav : 50	Stav : 51	Stav : 52
Stav : 53	Stav : 54	Stav : 55	Stav : 56
Stav : 57	Stav : 58	Stav : 59	Stav : 60
Stav : 61	Stav : 62	Stav : 63	Stav : 64
Stav : 65	Stav : 66	Stav : 67	Stav : 68
Stav : 69	Stav : 70	Stav : 71	Stav : 72
Stav : 73	Stav : 74	Stav : 75	Stav : 76
Stav : 77	Stav : 78	Stav : 79	Stav : 80
Stav : 81	Stav : 82	Stav : 83	Stav : 84
Stav : 85	Stav : 86	Stav : 87	Stav : 88
Stav : 89	Stav : 90	Stav : 91	Stav : 92
Stav : 93	Stav : 94	Stav : 95	Stav : 96
Stav : 97	Stav : 98	Stav : 99	Stav : 100

sen timača  
KONTAKT INŽENIERA STANICE  
Triedová 100, 811 01 Bratislava, SR

00-29239-0062



